



## Control handwheels

- **Black anodised aluminium** with knurled surface or with knurled surface and graduated ring (type S - scale 0...90, 100 graduations, for execution with collet z only).
- Light grey acetal resin based (POM) technopolymer **boss cap**.
- Black polyamide based (PA) technopolymer revolving **handle** (type D) or without handle (type A).
- Standard H8 tolerance reamed plain **hole** (bore type B), with DIN 6885/1 P9 keyway (bore type K) or with collet (type Z).

On request and for sufficient quantities, graduations and/or numbers can be engraved on diameter d1 using a computerised laser machine which produces perfectly legible graphics and numbers (when ordering, specify the graduation as described on page 349).



This product has been selected for its design by the international jury of "Die gute Industrieform-Hannover 1988"

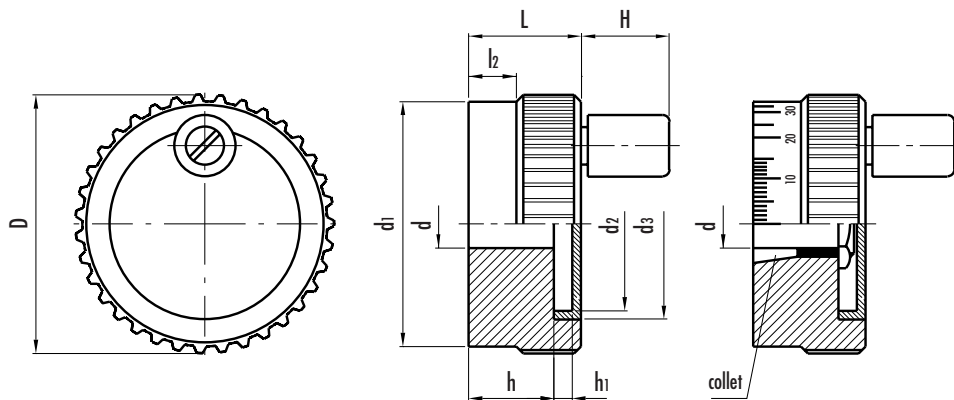

Standard elements	Main dimensions							Mounting hole		Handle	Weight
	D	L	l <sub>2</sub>	d <sub>1</sub>	d <sub>2</sub>	d <sub>3</sub>	h <sub>1</sub>	d H8	h	H	grams
GN 736.1-52-B10-A GN 736.1-52-B10-D	52	23	10	50	37	39.5	3.8	10	17	- 18	100 113
GN 736.1-62-B10-A GN 736.1-62-B10-D	62	23	10	60	47	49.5	3.8	10	17	- 20	142 156
GN 736.1-52-K10-A GN 736.1-52-K10-D	52	23	10	50	37	39.5	3.8	10	17	- 18	99 112
GN 736.1-62-K10-A GN 736.1-62-K10-D	62	23	10	60	47	49.5	3.8	10	17	- 20	141 155
GN 736.1-52-Z10-A GN 736.1-52-Z10-A-S GN 736.1-52-Z10-D GN 736.1-52-Z10-D-S	52	23	10	50	37	39.5	3.8	10	17	- - 18 18	111 110 120 121
GN 736.1-62-Z10-A GN 736.1-62-Z10-A-S GN 736.1-62-Z10-D GN 736.1-62-Z10-D-S	62	23	10	60	47	49.5	3.8	10	17	- - 20 20	154 155 165 167